

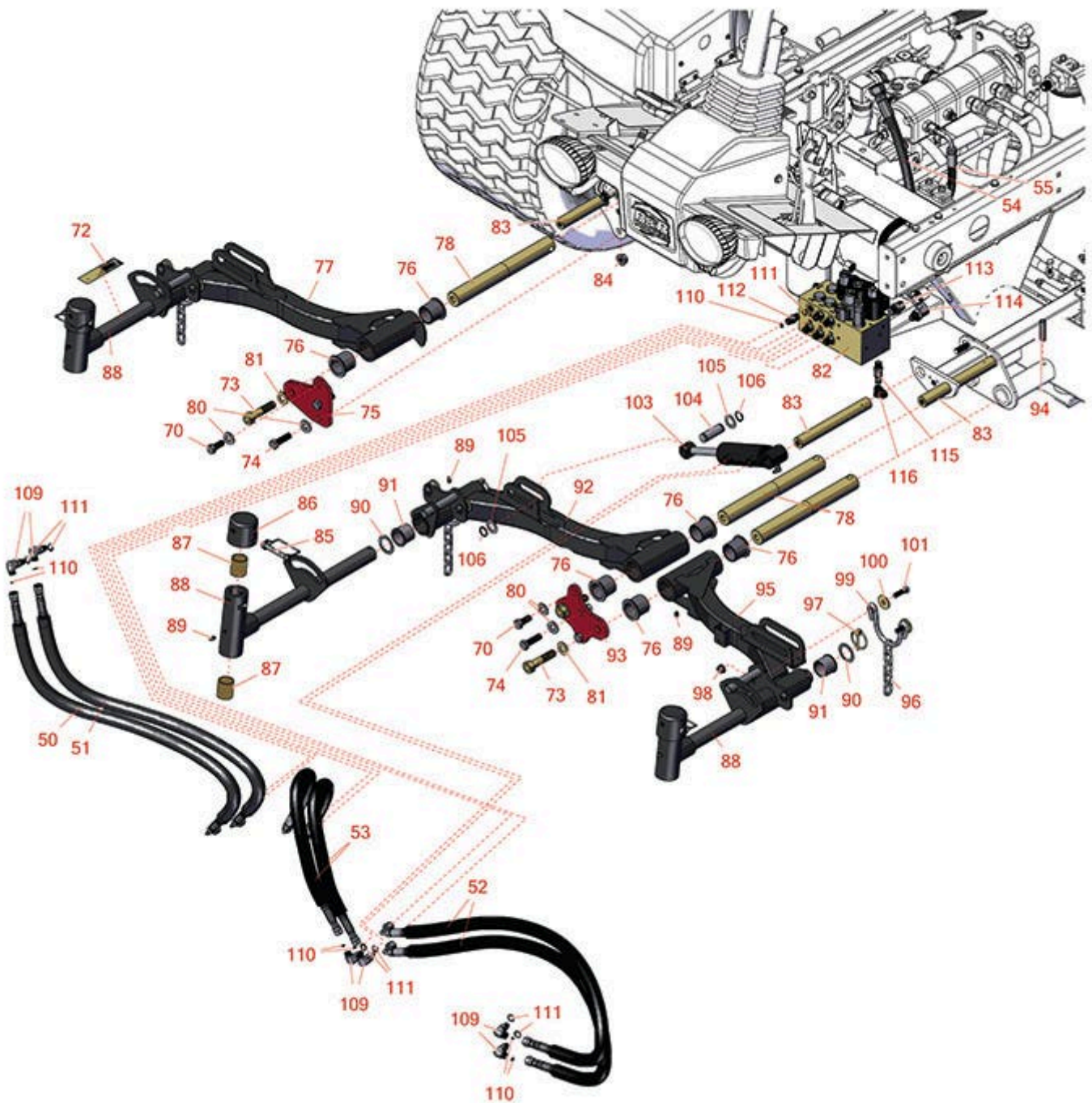

Replaces Toro Reelmaster 5510-G Parts

Traction Unit
Front Lift Arm



All original equipment manufacturers names and part numbers are used for identification purposes only, and we are in no way implying that our products are original equipment parts. Prices subject to change without notice.



Replaces Toro Reelmaster 5510-G Parts

Traction Unit
Front Lift Arm



Item No	R&R Part No.	OEM Part No.	Description	Qty Req	Order Quantity
Hoses					
50	R106-3693	106-3693	Hydraulic Hose Assy	1	
51	R106-3692	106-3692	Hydraulic Hose Assy	1	
52	R85-4940	85-4940	Hydraulic Hose Assy	2	
53	R93-6887	93-6887	Hydraulic Hose Assy	2	
54	R117-0180	117-0180	Hydraulic Hose Assy	1	
55	R92-5694	92-5694	Hydraulic Hose Assy	1	
Other Parts Available					
70	R325-5	01-150-0250, 01-178-0810, 19-8000, 20-86-AGD, 3226-1, 325-5, 513375	Bolt - Hex HD 1/2-13 x 1-1/4	2	
72	R110-9642	110-9642	Decal	3	
73	R327-7	01-150-0700, 01-150-0710, 01-178-1020, 20-125-AGD, 20-126-AGD, 327-7	Bolt - Hx HD	2	
74	R325-7	01-150-0380, 01-178-0814, 3226-3, 325-7, 48-9490	Bolt - 1/2-13 x 1 3/4 Hex HD Gr 5	4	
75	R117-5153-01	117-5153-01	Plate-Bridge 5	1	
76	R69-6470	69-6470	Bushing - Flanged	6	
77	R110-0995	110-0995	Lift Arm - No. 5	1	

All original equipment manufacturers names and part numbers are used for identification purposes only, and we are in no way implying that our products are original equipment parts. Prices subject to change without notice.



Replaces Toro Reelmaster 5510-G Parts

*Traction Unit
Front Lift Arm*



Item No	R&R Part No.	OEM Part No.	Description	Qty Req	Order Quantity
78	R117-0208	117-0208	Shaft- Pivot - Lift Arm	3	
80	R87-7270-01	87-7270, 87-7270-01	Washer - Flat 1/2	4	
81	R99-7667	99-7667	Washer - Flat 5/8	2	
82	R105-7577	105-7577	Manifold Assy - Lift Blocks	1	
83	R117-0148	117-0148	Pin - Hyd Cyl	3	
84	R32128-23	32128-23, 3218-23, 99-5107	Nut - Lock Hex Flanged 1/2-13	4	
85	R107-7400	107-7400	Pin - Lynch	3	
86	R107-4027	107-4027	Cap - Pivot Yoke	3	
87	R256-254	256-254	Bushing 1-1/8 x 1.375 x 1.5	6	
88	R107-2052	107-2052, 138-1248	Pivot Yoke Assy	3	
89	R302-5	21-6010, 302-11, 302-37, 302-47, 302-5, 302-57, 302-58, 302-6, 31-0300, 32-9660, 60-0800, 62-3880, 92-4181	Fitting - Grease	9	
90	R76-2980	76-2980	Washer - Thrust	6	
91	R104-0015	104-0015, 104-8339	Bushing - Flanged	6	
92	R110-0991	110-0991	Lift Arm - No. 1	1	

All original equipment manufacturers names and part numbers are used for identification purposes only, and we are in no way implying that our products are original equipment parts. Prices subject to change without notice.



Replaces Toro Reelmaster 5510-G Parts

*Traction Unit
Front Lift Arm*



Item No	R&R Part No.	OEM Part No.	Description	Qty Req	Order Quantity
93	R117-5154-01	117-5154-01	Plate-Bridge 1 and 4	1	
94	R32121-122	01-153-0140, 32121-122	Pin - Roll 1/2 x 2	3	
95	R114-8874	114-8874	Lift Arm - No. 4	1	
96	R84-2451	84-2451	Chain - Straight 5	3	
97	R92-1298	92-1298	Pin - Klik	3	
98	R104-8301	104-8301, 104-9301, 109-6658, 133-7570	Locknut - 3/8-16 Nylon Flanged	28	
99	R110-0922	110-0922	Hoop - Chain	3	
100	R63-8410	53-6380, 63-4810, 63-8410	Washer - Isolator Bushing	6	
101	R400264	01-150-0180, 01-178-0610, 20-48-AD, 20-48-AGD, 32-9160, 3224-3, 323-29, 323-7, 400264, 908035P	Bolt - Hex HD 3/8-16 x 1-1/4	6	
103	R119-6988	119-6988	Hydraulic Cylinder	1	
104	R104-0046	104-0046	Pin - Slide - Cylinder	3	
105	R3-6498	3--6498, 3-6498, 47-8270	Washer - Thrust	6	
106	R32120-93	32120-93	Snap Ring - HD	6	
109	R340-132	340-132	Hydraulic Fitting - 90 Deg	6	

All original equipment manufacturers names and part numbers are used for identification purposes only, and we are in no way implying that our products are original equipment parts. Prices subject to change without notice.



Replaces Toro Reelmaster 5510-G Parts

*Traction Unit
Front Lift Arm*



Item No	R&R Part No.	OEM Part No.	Description	Qty Req	Order Quantity
110	R237-21	237-21, 327-21	O-Ring	12	
111	R237-22	107-8844, 237-22, 237-78	O-Ring	12	
112	R340-92	340-92	Hydraulic Fitting - Striaight	6	
113	R340-4	340-4	Hydraulic Fitting - Male Connector	1	
114	R340-18	340-18	Hydraulic Fitting	1	
115	R59-7410	59-7410	Tip-Nipple	1	
116	R354-79	354-79	Cap-Dust	1	

All original equipment manufacturers names and part numbers are used for identification purposes only, and we are in no way implying that our products are original equipment parts. Prices subject to change without notice.