

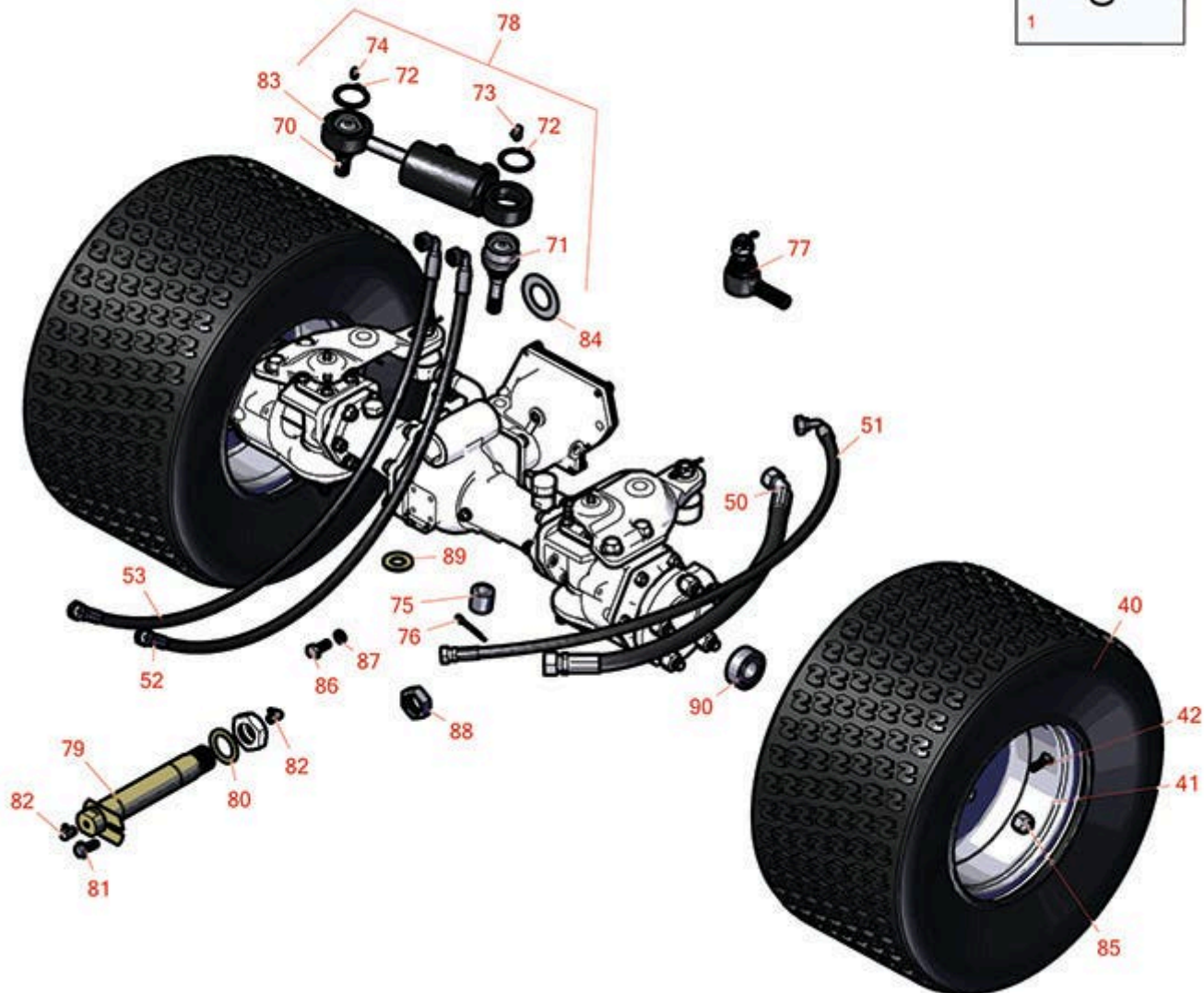

Replaces Toro Groundsmaster 4000-D Parts

Rotary Mower - Model 30609
Rear Wheels



All original equipment manufacturers names and part numbers are used for identification purposes only, and we are in no way implying that our products are original equipment parts. Prices subject to change without notice.



Replaces Toro Groundsmaster 4000-D Parts

Rotary Mower - Model 30609
Rear Wheels



Item No	R&R Part No.	OEM Part No.	Description	Qty Req	Order Quantity
---------	--------------	--------------	-------------	---------	----------------

Overhaul Kits and Service Tools

1	R125-4302	125-4302	Seal Kit - Cylinder Fits R121-1534 & R121-1535	1	
---	------------------	----------	--	---	--

Tires

40	RTK1010-6TF-I	120-8910	Tire - 20x10.00-10 (6 Ply) Kenda Super Turf	2	
----	----------------------	----------	---	---	--

41	R100-2582	100-2582, 120-8909, 217-120, 217-125	Rim - Rear Tire 10 x 7	2	
----	------------------	---	------------------------	---	--

42	R232-27	232-27, 232-31	Stem - Valve w/ Cap	2	
----	----------------	-------------------	---------------------	---	--

Hoses

50	R121-1458	121-1458	Hydraulic Hose Assy	1	
----	------------------	----------	---------------------	---	--

51	R121-1459	121-1459	Hydraulic Hose Assy	1	
----	------------------	----------	---------------------	---	--

52	R121-1500	121-1500	Hydraulic Hose Assy	1	
----	------------------	----------	---------------------	---	--

53	R121-1501	121-1501	Hydraulic Hose Assy	1	
----	------------------	----------	---------------------	---	--

Other Parts Available

70	R106-6774	106-6774, 92-5838, 92-5838-01	Ball Joint	1	
----	------------------	-------------------------------------	------------	---	--

71	R100-3795	100-3795	Ball Joint	1	
----	------------------	----------	------------	---	--

72	R32151-104	32151-104	Ring - Retaining, Ex	2	
----	-------------------	-----------	----------------------	---	--

73	R302-60	302-60	Zerk - Grease 90 Deg.	1	
----	----------------	--------	-----------------------	---	--

All original equipment manufacturers names and part numbers are used for identification purposes only, and we are in no way implying that our products are original equipment parts. Prices subject to change without notice.



Replaces Toro Groundsmaster 4000-D Parts

Rotary Mower - Model 30609
Rear Wheels



Item No	R&R Part No.	OEM Part No.	Description	Qty Req	Order Quantity
74	R302-5	21-6010, 302-11, 302-37, 302-47, 302-5, 302-57, 302-58, 302-6, 31-0300, 32-9660, 60-0800, 62-3880, 92-4181	Fitting - Grease	3	
75	R100-3796	100-3796	Spacer - Ball Joint	1	
76	R3272-12	01-151-0090, 28-19-D, 3272-12	Pin - Cotter 1/8 x 1-1/4	1	
77	R106-1113	100-3852, 106-1113	Tie Rod End Assy RH Thread	2	
78	R121-1535	121-1535	Steering Cylinder Assy - Includes Ball Joints	1	
79	R98-7077	98-7077	Axle Pin - Rear	1	
80	R92-1765	92-1765	Washer - Thrust	1	
81	R32144-14	32104-32, 32104-49, 32144-14	Bolt - Hex Washer 5/16-18 x 5/8	1	
82	R323016	302-33, 323016	1/8"-NPT 90 Degree Grease Fitting	2	
83	R121-1534	121-1534	Steering Cylinder	1	
84	R99-8432	99-8432	Washer - Thrust	2	
85	R93-5268	93-5268	Nut - M12-1.5 Wheel	10	
86	R43-0090	43-0090, 95-8812	Bolt - 10mm x 1.25 x 25 Hex HD	4	

All original equipment manufacturers names and part numbers are used for identification purposes only, and we are in no way implying that our products are original equipment parts. Prices subject to change without notice.



Replaces Toro Groundsmaster 4000-D Parts

Rotary Mower - Model 30609
Rear Wheels



Item No	R&R Part No.	OEM Part No.	Description	Qty Req	Order Quantity
87	R48-9590	01-176-0040, 42-9600, 48-9590, 48-9690, 63-7780	Washer - Lock 10mm	4	
88	R340-126	340-126	Nut - Bulkhead	2	
89	R92-5836	92-5836	Flat Washer - Hardened	1	
90	R99-7534	99-7534	Bearing - Double Row Ball	2	

All original equipment manufacturers names and part numbers are used for identification purposes only, and we are in no way implying that our products are original equipment parts. Prices subject to change without notice.