

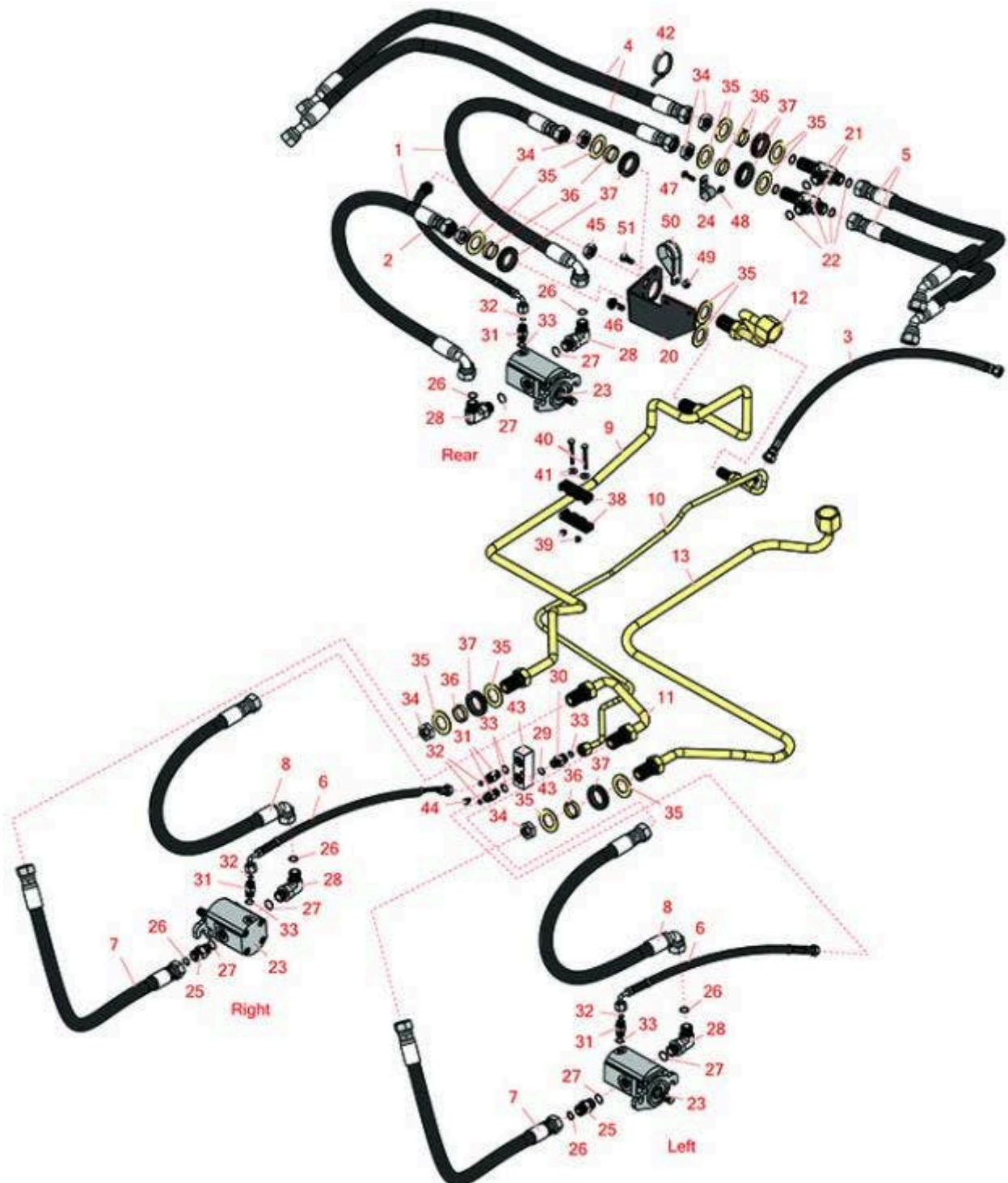

Replaces Toro Greensmaster 3200 & 3200-D Parts

Traction Unit
Hydraulics



All original equipment manufacturers names and part numbers are used for identification purposes only, and we are in no way implying that our products are original equipment parts. Prices subject to change without notice.



Replaces Toro Greensmaster 3200 & 3200-D Parts

Traction Unit
Hydraulics



Item No	R&R Part No.	OEM Part No.	Description	Qty Req	Order Quantity
Hoses					
1	R95-2907	95-2907	Hydraulic Hose Assy - Rear Reel Motor	2	
2	R94-1328	94-1328	Hydraulic Hose Assy - Rear Reel Motor	1	
3	R94-4539	94-4539	Hydraulic Hose Assy	1	
4	R94-5357	94-5357	Hydraulic Hose Assy	2	
5	R94-5358	94-5358	Hydraulic Hose Assy	2	
6	R93-2264	93-2264	Hydraulic Hose Assy	2	
7	R95-2908	105-5403, 93-2262, 95-2908	Hydraulic Hose Assy - Reel Motor	2	
8	R95-2909	93-2263, 95-2909	Hydraulic Hose Assy - Reel Motor	2	
9	R94-1318	94-1318	Tube-Hyd	1	
10	R94-1321	94-1321	Tube-Hyd	1	
11	R94-1319	94-1319	Tube - Hyd	1	
12	R94-1317	94-1317	Tube-Hyd	1	
13	R94-1320	94-1320	Tube-Hyd	1	
Other Parts Available					
20	R94-1316	94-1316	Bracket- Bulkhead	1	
21	R94-5350	94-5350	Tee-Bulkhead	2	
22	R237-65	237-65, 237.65	O-Ring	6	

All original equipment manufacturers names and part numbers are used for identification purposes only, and we are in no way implying that our products are original equipment parts. Prices subject to change without notice.



Replaces Toro Greensmaster 3200 & 3200-D Parts

*Traction Unit
Hydraulics*



Item No	R&R Part No.	OEM Part No.	Description	Qty Req	Order Quantity
23	R120-2072	100-6426, 108-6487, 112-9200, 120-2072, 93-1375	Hydraulic Gear Motor	3	
24	R2412-134	2412-134	R-Clamp	1	
25	R340-4	340-4	Hydraulic Fitting - Male Connector	2	
26	R237-30	23-6320, 237-30	O-Ring - Seal	6	
27	R237-79	237-79	O-Ring	6	
28	R340-98	340-98	Hydraulic Fitting	4	
29	R237-42	237-42, 31-4160	O-Ring	1	
30	R340-2	340-2, 60-1920	Hydraulic Fitting - Striaight	1	
31	R340-92	340-92	Hydraulic Fitting - Striaight	5	
32	R237-21	237-21, 327-21	O-Ring	5	
33	R237-22	107-8844, 237-22, 237-78	O-Ring	6	
34	R340-74	340-74	Locknut - Bulkhead	4	
35	R69-9010	69-9010, 9-9010	Washer	8	
36	R69-9000	125-1984, 69-9000	Spacer	4	
37	R240-3	240-3	Grommet- Rubber	6	
38	R93-2509	93-2509	Clamp - Tube	2	

All original equipment manufacturers names and part numbers are used for identification purposes only, and we are in no way implying that our products are original equipment parts. Prices subject to change without notice.



Replaces Toro Greensmaster 3200 & 3200-D Parts

Traction Unit
Hydraulics



Item No	R&R Part No.	OEM Part No.	Description	Qty Req	Order Quantity
39	R33023-00	33023-00, 48-7900, 49-7810	Locknut - ESNA 6mm x 1.0	2	
40	R33113-050	33113-050, 60-6650	Screw - Hx HD 6mm	2	
41	R453023	3256-1, 3256-22, 3256-72, 33094-00	Washer - Flat 1/4	2	
42	R3290-378	30-1740, 3290-378, 52-6570, 60-4340	Cable Tie	1	
43	R93-2238	93-2238	T - Block	1	
44	R33113-008	33113-008	Bolt - Hex HD M6-1.0 x 8	1	
45	R340-70	340-70	Nut - Lock	1	
46	R32144-14	32104-32, 32104-49, 32144-14	Bolt - Hex Washer 5/16-18 x 5/8	6	
47	R33113-020	33113-020	Bolt - Hx HD	2	
48	R3256-22	24-9-BD, 3-1032, 3256-1, 3256-22, 93-0954, 93-0989	Washer - Flat 1/4 Yellow	2	
49	R33024-00	33024-00	Locknut - 8mm x 1.25	1	
50	R2412-137	2412-137	Clamp-R, Double	1	
51	R66-3160	33114-020, 43-0110, 48-7710, 66-3160	Bolt - Flanged Hex HD	1	

All original equipment manufacturers names and part numbers are used for identification purposes only, and we are in no way implying that our products are original equipment parts. Prices subject to change without notice.