

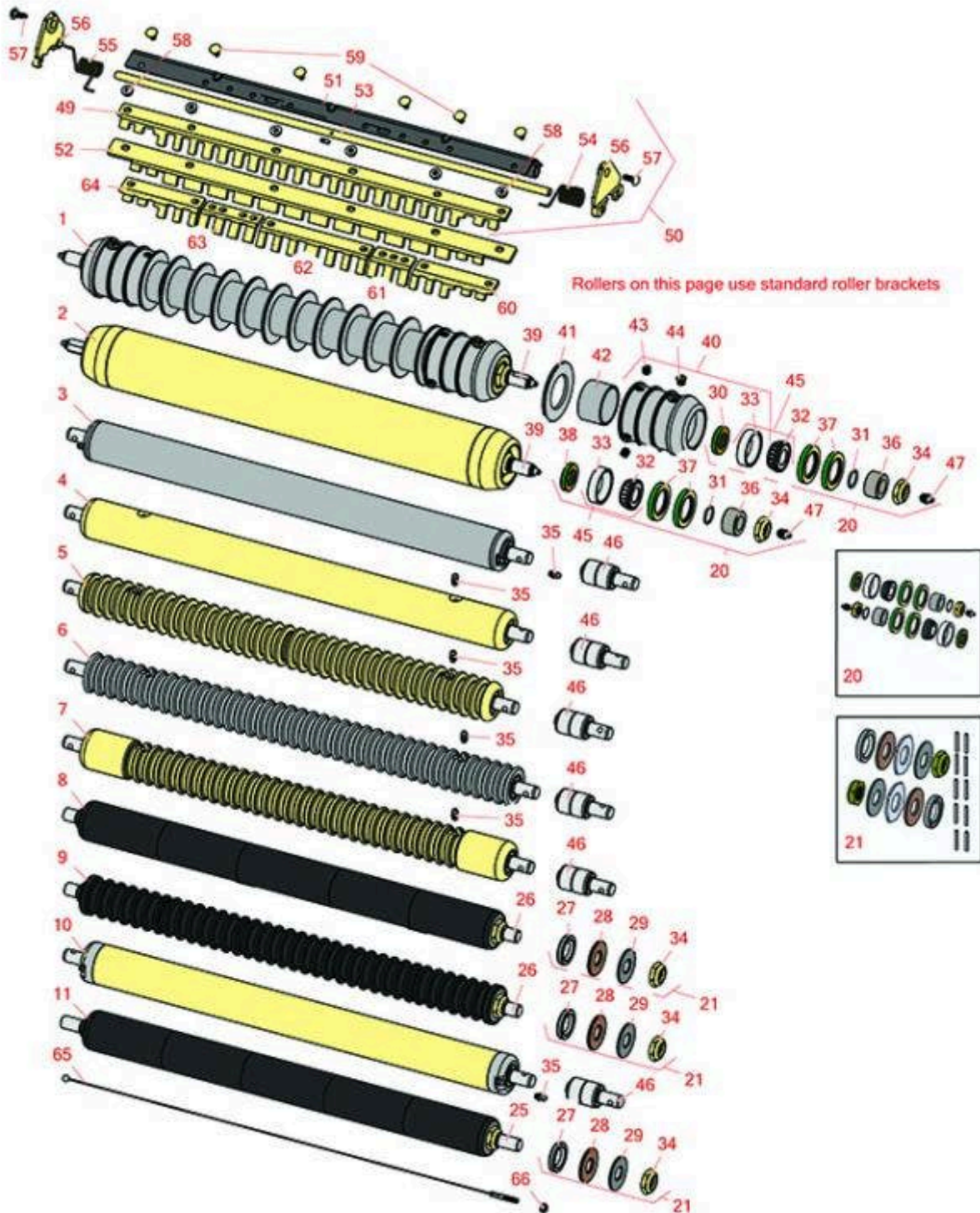

# Replaces John Deere 2500B Riding Greens Mower Parts

Cutting Unit - Serial up to 030000  
Rollers



All original equipment manufacturers names and part numbers are used for identification purposes only, and we are in no way implying that our products are original equipment parts. Prices subject to change without notice.



# Replaces John Deere 2500B Riding Greens Mower Parts

Cutting Unit - Serial up to 030000  
Rollers



| Item No  | R&R Part No.     | OEM Part No.                     | Description                           | Qty Req | Order Quantity |
|--|------------------|----------------------------------|---------------------------------------|---------|----------------|
| 1  | <b>R500512</b>   | AMT2966,<br>BM25317              | Roller - Grooved Repairable Steel     | 1       |                |
| <i>Tech Note: Constructed with a through shaft and greasable ball bearings. This roller can be repaired by unscrewing the ends and replacing the series of washers and spacers.:</i> |                  |                                  |                                       |         |                |
| 2  | <b>RAET11263</b> | AET11263,<br>AMT2967             | Roller - Smooth Tubular Steel         | 1       |                |
| <i>Tech Note: Constructed with a through shaft, this heavy duty roller uses greasable tapered bearings for extended life.:</i>   |                  |                                  |                                       |         |                |
| 3  | <b>RAET10111</b> | AET10111,<br>AMT2876             | Roller - Smooth Tubular Steel         | 1       |                |
| <i>Tech Note: This tubular steel roller uses greasable "water-pump" style bearings.:</i>   |                  |                                  |                                       |         |                |
| 4  | <b>RAMT1442</b>  | AMT1442,<br>AMT2878              | Roller - Smooth Solid Steel           | 1       |                |
| <i>Tech Note: Machined from solid steel, this heavy weight roller uses greasable "water-pump" style bearings.:</i>   |                  |                                  |                                       |         |                |
| 5  | <b>RAET10954</b> | AET10954,<br>AMT2875,<br>AMT2879 | Roller - Grooved Machined Solid Steel | 1       |                |
| <i>Tech Note: Machined from solid steel, this heavy weight roller uses greasable "water-pump" style bearings.:</i>   |                  |                                  |                                       |         |                |
| 6  | <b>RAMT1061</b>  | AET10557,<br>AMT1061,<br>AMT2877 | Roller - Grooved Machined Solid Steel | 1       |                |
| <i>Tech Note: Machined from solid steel, this heavy weight roller uses greasable "water-pump" style bearings.:</i>   |                  |                                  |                                       |         |                |
| 7  | <b>RAMT1443</b>  | AMT1443,<br>AMT2879              | Roller - Grooved Machined Solid Steel | 1       |                |
| <i>Tech Note: Machined from solid steel, this heavy weight roller uses greasable "water-pump" style bearings. Extended length body.:</i>   |                  |                                  |                                       |         |                |

All original equipment manufacturers names and part numbers are used for identification purposes only, and we are in no way implying that our products are original equipment parts. Prices subject to change without notice.



# Replaces John Deere 2500B Riding Greens Mower Parts

Cutting Unit - Serial up to 030000  
Rollers



| Item No | R&R Part No. | OEM Part No. | Description | Qty Req | Order Quantity |
|---------|--------------|--------------|-------------|---------|----------------|
|---------|--------------|--------------|-------------|---------|----------------|

|   |                |  |                                   |   |  |
|---|----------------|--|-----------------------------------|---|--|
| 8   | <b>R120255</b> |  | Roller - Smooth UHMW Polyethylene | 1 |  |
| <i>Tech Note: Machined from solid UHMW, this low maintenance roller uses a 1" solid stainless steel shaft and requires no grease. UHMW material prevents build-up of debris.:</i> |                |  |                                   |   |  |

|   |                |  |                                    |   |  |
|---|----------------|--|------------------------------------|---|--|
| 9   | <b>R120250</b> |  | Roller - Grooved UHMW Polyethylene | 1 |  |
| <i>Tech Note: Machined from solid UHMW, this low maintenance roller rotates around a 1" solid stainless steel shaft and requires no bearings or grease. Patented groove design and smooth UHMW material prevents build-up of debris.:</i> |                |  |                                    |   |  |

## R&R Rear Rollers

|  |                 |         |                               |   |  |
|--|-----------------|---------|-------------------------------|---|--|
| 10   | <b>RAMT1060</b> | AMT1060 | Roller - Smooth Tubular Steel | 1 |  |
| <i>Tech Note: This tubular steel roller uses greasable "water-pump" style bearings.:</i> |                 |         |                               |   |  |

|   |                |  |                                   |   |  |
|---|----------------|--|-----------------------------------|---|--|
| 11  | <b>R120260</b> |  | Roller - Smooth UHMW Polyethylene | 1 |  |
| <i>Tech Note: Machined from solid UHMW, this low maintenance roller uses a 1" solid stainless steel shaft and requires no grease. UHMW material prevents build-up of debris.:</i> |                |  |                                   |   |  |

## Overhaul Kit

|   |                  |          |                       |   |  |
|---|------------------|----------|-----------------------|---|--|
| 20  | <b>RAET10632</b> | AET10632 | Overhaul Kit - Roller | 1 |  |
| <i>Tech Note: Includes 4 ea: RET15755 Seal; 2 ea: R237-54 O-Ring, R253-122 Seal, R254-78 Bearing, R254-79 Cup, R3296-15 Locknut, R471219 Grease Zerk, RET15726 Sleeve, RET15756 Seal:</i> |                  |          |                       |   |  |

|  |                |  |                            |   |  |
|--|----------------|--|----------------------------|---|--|
| 21   | <b>R101395</b> |  | Overhaul Kit - UHMW Roller | 1 |  |
| <i>Tech Note: Fits all R&amp;R 2" Dia. Black UHMW Polyethylene Rollers. Includes 10 ea.: R150322 Roll Pins; 2 ea.: R3296-15 Locknuts, R150347T Teflon Seals, R150333 Thrust Washers, &amp; R150334A Bronze Thrust Washers:</i> |                |  |                            |   |  |

## Other Parts Available

|    |                |  |                           |   |  |
|----|----------------|--|---------------------------|---|--|
| 25 | <b>R120261</b> |  | Shaft - 1 SS Rear Roller  | 1 |  |
| 26 | <b>R120251</b> |  | Shaft - 1 SS Front Roller | 1 |  |

All original equipment manufacturers names and part numbers are used for identification purposes only, and we are in no way implying that our products are original equipment parts. Prices subject to change without notice.



# Replaces John Deere 2500B Riding Greens Mower Parts

Cutting Unit - Serial up to 030000  
Rollers



| Item No  | R&R Part No. | OEM Part No.                 | Description                    | Qty Req | Order Quantity |
|--|--------------|------------------------------|--------------------------------|---------|----------------|
| 27   | R150347T     |                              | Seal - Nonstick Lip            | 2       |                |
| 28   | R150334A     |                              | Washer - Thrust SAE660 Bronze  | 2       |                |
| 29   | R150333      |                              | Washer - Flat Keyed Outer SS   | 2       |                |
| 30   | R253-122     | 253-122                      | Seal                           | 2       |                |
| 31   | R237-54      | U46731,<br>U6731             | O-Ring - Small                 | 2       |                |
| 32   | R254-78      | JD8188                       | Tapered Bearing Cone           | 2       |                |
| 33   | R254-79      | JD8226                       | Cup - Bearing                  | 2       |                |
| <i>Tech Note: Use R254-79M installation mandrel to properly install race.:</i> |              |                              |                                |         |                |
| 34   | R3296-15     | N101345                      | Locknut - 3/4-16 Nylon Jam     | 2       |                |
| 35   | R302-5       | JD7797,<br>JD7842,<br>JD7844 | Fitting - Grease               | 2       |                |
| 36   | RET15726     | ET15726,<br>RET15726         | Sleeve - Wear Hardened         | 2       |                |
| 37   | RET15755     | ET15755                      | Seal - Oil                     | 4       |                |
| 38   | RET15756     | ET15756,<br>MT1739,<br>MT739 | Seal                           | 2       |                |
| 39   | RET17515     | ET17515                      | Shaft - Roller                 | 1       |                |
| 40   | R500511      |                              | Roller End - Threaded 3        | 2       |                |
| 41   | R150673      |                              | Washer - 3 Repairable Roller   | 11      |                |
| 42   | R150676      |                              | Spacer - 2-3/4 Dia x 1-1/4 L   | 10      |                |
| 43   | R150691      |                              | Screw - Set Nyloc 3/8-16 x 3/8 | 4       |                |
| 44   | R170714      | E14814                       | Fitting - Pressure Relief      | 2       |                |

All original equipment manufacturers names and part numbers are used for identification purposes only, and we are in no way implying that our products are original equipment parts. Prices subject to change without notice.



# Replaces John Deere 2500B Riding Greens Mower Parts

Cutting Unit - Serial up to 030000  
Rollers



| Item No   | R&R Part No.    | OEM Part No.                      | Description                  | Qty Req | Order Quantity |
|---|-----------------|-----------------------------------|------------------------------|---------|----------------|
| 45  | <b>R500534</b>  |                                   | Bearing - with Cup           | 2       |                |
| 46  | <b>RAA35741</b> | AA35741,<br>AET10129,<br>TCA22836 | Bearing                      | 2       |                |
| <i>Tech Note: 1/4" Side Hole:</i>   |                 |                                   |                              |         |                |
| 47  | <b>R471219</b>  | 471219,<br>JD7759,<br>JD7798      | Zerk - Grease                | 2       |                |
| 49  | <b>R500558</b>  |                                   | Scraper - Grooved Roller     | 1       |                |
| <i>Tech Note: 1 Piece Scraper fits OEM AET11262 &amp; AMT2966 Grooved Roller:</i> |                 |                                   |                              |         |                |
| 50  | <b>R500559</b>  | BM18680,<br>MT18680               | Scraper Kit - Grooved Roller | 1       |                |
| <i>Tech Note: Fits John Deere AET11262 &amp; AMT2966 Grooved Roller Only:</i>     |                 |                                   |                              |         |                |
| 50  | <b>R500573</b>  |                                   | Scraper Kit - SET/5          | 1       |                |
| <i>Tech Note: Fits R&amp;R R500512 Roller Only &amp; Incl R500572 Scraper:</i>    |                 |                                   |                              |         |                |
| 51  | <b>R500571</b>  | MT2369                            | Bar - Scraper                | 1       |                |
| 52  | <b>R500572</b>  |                                   | Scraper - Fits R500512 Only  | 1       |                |
| 53  | <b>RET17757</b> | ET11757,<br>ET17757               | Pin - Scraper                | 1       |                |
| 54  | <b>RET17629</b> | ET17629                           | Spring - Torsion LH          | 1       |                |
| 55  | <b>RET17630</b> | ET17630                           | Spring - Torsion RH          | 1       |                |
| 56  | <b>RMT2407</b>  | MT2407                            | Bracket - Roller Scraper     | 2       |                |
| 57  | <b>R03M7221</b> | 03M7221                           | Bolt - Carriage M6 x 16      | 5       |                |
| 58  | <b>R14M7303</b> | 14M7303                           | Nut - 6mm x 1.0 Flanged      | 5       |                |
| 59  | <b>R03M7251</b> | 03M7251                           | Bolt - Gr. Roller Scraper    | 5       |                |

All original equipment manufacturers names and part numbers are used for identification purposes only, and we are in no way implying that our products are original equipment parts. Prices subject to change without notice.



# Replaces John Deere 2500B Riding Greens Mower Parts

*Cutting Unit - Serial up to 030000  
Rollers*

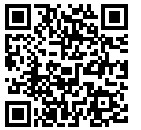

| Item No | R&R Part No.     | OEM Part No.       | Description                       | Qty Req | Order Quantity |
|---------|------------------|--------------------|-----------------------------------|---------|----------------|
| 60      | <b>RMT5159</b>   | MT5159             | Scraper - Fits J.D. LH End        | 1       |                |
| 61      | <b>RMT2342</b>   | MT2342             | Section - Grooved Scraper 3 Tooth | 2       |                |
| 62      | <b>RMT2340</b>   | MT2340             | Scraper - Fits J.D. Center        | 1       |                |
| 63      | <b>RMT2341</b>   | MT2341             | Section - Grooved Scraper 4 Tooth | 2       |                |
| 64      | <b>RMT5158</b>   | MT5158             | Scraper - Fits J.D. RH End        | 1       |                |
| 65      | <b>RTCA19566</b> | TCA19566           | Cable - Smooth Roller Scraper     | 1       |                |
| 66      | <b>RU45916</b>   | 14M7298,<br>U45916 | Locknut - 10-24 ESNA              | 2       |                |

All original equipment manufacturers names and part numbers are used for identification purposes only, and we are in no way implying that our products are original equipment parts. Prices subject to change without notice.