

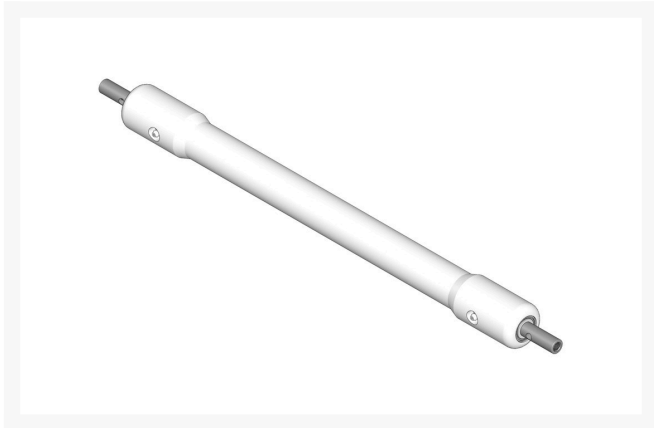

# Roller - Swaged Machined Solid Aluminum

R21-6470



## Details

Constructed with "water-pump" style bearings, this roller is machined from solid aluminum and contacts the ground only on the outer 2-7/8" of the roller.

## Replaces

R&R Products	R10-5000, R52-3590
Toro	10-5000, 21-6470, 52-3590

## Specifications

Manufacturer	R&R Products
Overhaul Kit No.	R107-1588
Roller Body	2 in
Diameter	
Weight (lbs)	4 lb

## Fits Models

- R&R Products Greens Max 2200LP
- R&R Products Versa-Green 1860
- R&R Products Versa-Green 1860PS
- Toro Greensmaster 1000
- Toro Greensmaster 1010
- Toro Greensmaster 2000
- Toro Greensmaster 3
- Toro Greensmaster 300
- Toro Greensmaster 3000
- Toro Greensmaster 3050
- Toro Greensmaster 3100
- Toro Greensmaster 3150-Q
- Toro Greensmaster Series 4

**Krima Trading AB**

Stene 710 Kumla, 692 93

+46 19 57 35 20

<https://krima.rproducts.com/>



# Roller - Swaged Machined Solid Aluminum

R21-6470



## Replacement Parts

R107-1588

R52-3180

R302-5

Overhaul Kit - Roller

Bearing - Front Roller

Fitting - Grease

**Krima Trading AB**

Stene 710 Kumla, 692 93

+46 19 57 35 20

<https://krima.rrproducts.com/>