

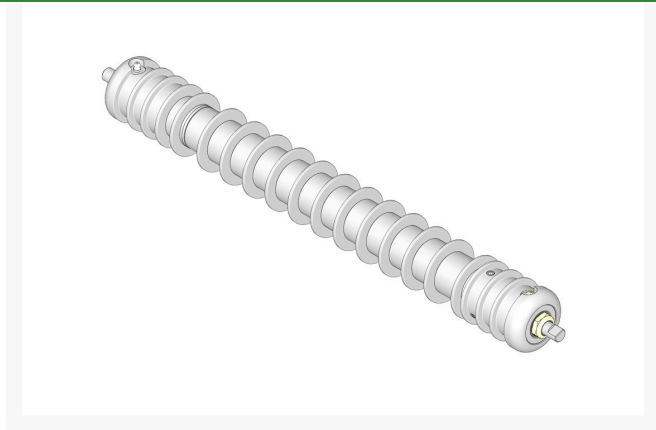

# Roller - Grooved Repairable Steel - 26

R104100



## Details

Constructed with a through shaft and greasable ball bearings, this roller can be repaired by unscrewing the ends and replacing the series of washers and spacers.

## Replaces

Jacobsen	116906, 123266
R&R Products	R116906, R131898

## Specifications

Manufacturer	R&R Products
Overhaul Kit No.	R100137
Roller Body	3 in
Diameter	
Weight (lbs)	20 lb

## Fits Models

Jacobsen LF-3810  
Jacobsen Tri-King 1471  
Jacobsen Tri-King 1670  
Jacobsen Tri-King 1671  
Jacobsen Tri-King 1671D  
Jacobsen Tri-King 1671G  
Jacobsen Tri-King 1672D  
Jacobsen Tri-King 1684D  
Jacobsen Tri-King 1800G  
Jacobsen Tri-King 1900D

## Replacement Parts

R100103	Roller End - Grooved
R100137	Overhaul Kit - Roller
R500534	Bearing - with Cup
R104102	Shaft - 26 Roller

**Krima Trading AB**

Stene 710 Kumla, 692 93

+46 19 57 35 20

<https://krima.rrproducts.com/>



# Roller - Grooved Repairable Steel - 26

R104100



---

R150676	Spacer - 2-3/4 Dia x 1-1/4 L
R150673	Washer - 3 Repairable Roller
R150678	Spacer - Grooved Roller 3/4
R150676A	Spacer - 1/8
R150691	Screw - Set Nyloc 3/8-16 x 3/8
R170714	Fitting - Pressure Relief
R302-5	Fitting - Grease
R253-122	Seal
R254-79	Cup - Bearing
R254-78	Tapered Bearing Cone
R253-117	Seal - Outer Triple Lip
R5-4038	Sleeve - Wear Reel Shaft
R3296-15	Locknut - 3/4-16 Nylon Jam

**Krima Trading AB**

Stene 710 Kumla, 692 93

+46 19 57 35 20

<https://krima.rrproducts.com/>