

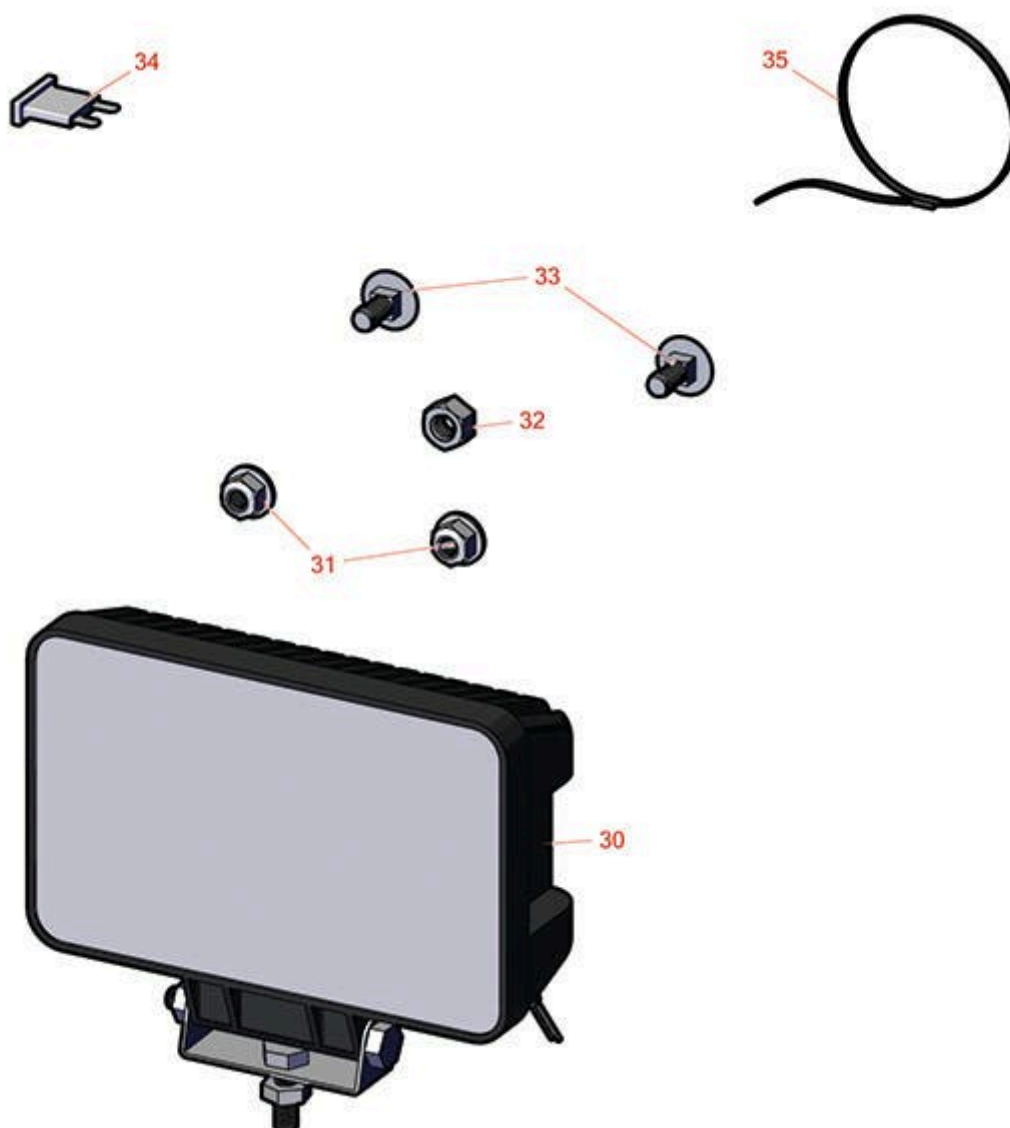

Replaces Toro Groundsmaster 3500-D Parts

Rotary Mower - Model 30807, 30839, 30843

Work Light - Model 30841



All original equipment manufacturers names and part numbers are used for identification purposes only, and we are in no way implying that our products are original equipment parts. Prices subject to change without notice.



Replaces Toro Groundsmaster 3500-D Parts

Rotary Mower - Model 30807, 30839, 30843
Work Light - Model 30841



Item No	R&R Part No.	OEM Part No.	Description	Qty Req	Order Quantity
30	R151712	108-6471, 112-9177, 94-9024	LED Oval Work Light - 12 LED 30w	2	
31	R445722	30-8980, 32128-2, 32128-20, 32128-20	Nut - Serrated Washer	2	
32	R443106	01-188-0518, 22-12-AJD, 32111-4, 3217-4, 3217-6, 3218-2, 513295, 513412, 915112P, 915978, 915979	Nut - 5/16-18 Y/Zinc Plated	1	
32	RP457-2	01-191-0518, 22-12-AJK, 3218-2, 513299, P457-2	Nut - Jam 5/16-18 Zinc	1	
33	R3230-1	01-173-0506, 3230-1, 3230-20, 900037P	Bolt - Carriage 5/16-18 x 3/4	2	
34	R218-578	218-578, 95-2438	Fuse - 10 Amp	1	
35	R3290-379	3290-336, 3290-379	Cable Tie - 6in	10	

All original equipment manufacturers names and part numbers are used for identification purposes only, and we are in no way implying that our products are original equipment parts. Prices subject to change without notice.